

GEMINI Juice ||93||



Thank you for choosing a Zerica® water dispenser.

Using the appliance is simple, however for best results, it is important to read the following instructions.

Please visit www.zerica.it to download the product manual or contact us at our address below to request one

(010)

GEMINI JUICE 1931 is the most compact and revolutionary dispenser ever produced.

Everything needed for a water dispenser can be found in just 33,5 x 43,5 x 71,5 cm.

- 2 or 3 fruit juices from concentrate supply
- Cold water dispensing
- Sparkling water dispensing
- Filtration System Compartment
- CO₂ gas cylinder with CO₂ reducing valve
- 7" Touch screen

GEMINI JUICE 1931 has been designed for the end user offering simple handling of: thermostat for temperature control, filter replacement (optional), replacement of juice concentrate cartridges.

Using the appliance is simple, however for best results, it is important to read the following instructions.

GMN T G012 200 model dispenses cold, cold-sparkling water and two kinds of fruit juice from concentrate.

GMN T G012 300 model dispenses cold, cold-sparkling water and three kinds of fruit juice from concentrate.

1. INTRODUCTION
2. BOX CONTENT
3. UNPACKING
4. POSITIONING
5. FILTER CARTRIDGE FITTED SYSTEM
6. CARTRIDGE INSTALLATION/REPLACEMENT
7. WATER CONNECTION
8. CARBON DIOXIDE CONNECTION
9. CARBON DIOXIDE PRESSURE REDUCER CONTROL
10. ELECTRICAL CONNECTION
11. DISPENSING KEYBOARD
12. FIRST POWER-ON
13. TOUCH SCREEN POWER ON
14. BAG IN BOX POSITIONING
15. WATER - CONCENTRATE MIXING CONTROL
16. GLASS / CARAFE SUPPORT INSTALLATION
17. THERMOSTAT CONTROL
18. ALARM WARNINGS
19. COOLING CIRCUIT MAINTENANCE
20. WATER CIRCUIT MAINTENANCE
21. DRIP TRAY AND FRONT PANEL MAINTENANCE
22. FRONT PANEL REMOVAL
23. CONCENTRATES CIRCUIT MAINTENANCE
24. RINSING FRUIT JUICE LINES (*serial number from 105300*)
25. MAINTENANCE CHART
26. DEMOLITION AND DISMANTLING
27. WARRANTY
28. EC DECLARATION OF CONFORMITY

1.

INTRODUCTION

This manual is the documentation and an integral part of the appliance and must accompany the product even if it is transferred or sold after first installation.

Its disclosure to all interested parties is a prerequisite for correct operation and protection from possible accidents and damage to the appliance and injury to third parties.

These instructions are intended to provide information regarding correct installation and operation.

The presence of such warnings does not imply that the manufacturer assumes any liability for any damage to property or injury to third parties caused by the use of the device, which has all the original certifications required in order to make it suitable for the use for which it has been designed, as well as safe in compliance with applicable standards.

The reproduction of the contents of this manual for distribution to third parties is strictly forbidden without the express prior consent of the manufacturer Zerica S.r.l.

This appliance is not intended for use by persons (including children) with reduced physical, sensory or mental capabilities, or lack of experience and knowledge, unless they have been given supervision or instructions concerning the use of the appliance by a person responsible for their safety. Children must be supervised to assure that they do not play with the machine.

The appliance must not be installed near water jets.

The appliance needs to be installed on a flat surface.

The appliance must not be cleaned with water jets.

The appliance is compliant with the N climate class and must be installed in locations with a temperature between +16°C and +32°C. Take all necessary precautions and do not install in locations with temperatures lower than +3°C because if the water inside the product freezes, it seriously damages the water circuit.

This appliance generates a sound pressure level below 70dB.

(020)

2. BOX CONTENT

The package contains:

- a. N. 1 dispenser for cold water, cold sparkling water and 2 or 3 fruit juices from concentrates.
- b. N. 1 Co2 disposable cylinder - NOT REFILLABLE - for food-grade carbon dioxide
- c. N. 1 filtration cartridge for drinking water (refer to the proper paragraph for further details)
- d. N. 1 Power cable
- e. N. 1 drip tray equipped with a small grid
- f. N. 1 wide drip tray with housings for fastening at different levels

3.

UNPACKING

Place the appliance in the upright position which can be easily identified by reading the direction mark “UP” on the box.

Open the package and check that there are no dents or obvious damages to the appliance caused by transportation.

Any defects must be notified within 24 hours from delivery.

In case of obvious defects or dents, do not install the appliance.

The packaging must be disposed of by the customer in accordance with current environmental protection regulations.

(030)

Open the front panel. The keys are fixed on the grill of the drip tray. Take out all the accessories.

4. POSITIONING

Position the cooler in a clean, ventilated place and keep away from heat sources.

Leave a gap of at least 5 cm on each side and 25 cm by the ventilation slots.

If the ventilation slots are covered, the cooling system cannot operate properly and this inevitably leads to malfunctioning.

Do not place any objects on top of the product.



Caution: non-compliance with the above conditions causes the compressor to overheat and break, leading to immediate invalidation of the warranty.

For proper installation and use of the appliance, refer to the “First power on” paragraph.

(040)

5. FILTER CARTRIDGE FITTED SYSTEM

The filter cartridge is placed behind the frontal panel.

Zerica code for the filter cartridge replacement is:

- CARCBA 017

If necessary, it is possible to install a limescale filter (code: CARCBA 017 01) or an empty cartridge (code: CARCBA 017 90) to be filled with a disinfectant solution.

To install the filter, open the front panel by the lock located on the right side of the product:



Whilst complying with the rules and regulation in force, this product can also operate without any filtration system. Then, connection to the water main can therefore be performed with no need to insert the filtration cartridge.



6. CARTRIDGE INSTALLATION/REPLACEMENT (optional)

The cartridge must be replaced in compliance with the data shown on the label, both for the months of use and the litres dispensed.



Caution: before performing any intervention:
disconnect the system from the water supply network or close the water inlet valve.

WARNING

To reduce the risk associated with choking:

- To reduce the risk associated with choking, do not allow children under 3 years of age to have access to small parts during the installation of the product.

To reduce the risk associated with the ingestion of contaminants due to the use of microbiologically unsafe water or of unknown quality:

- Do not use with water that is microbiologically unsafe or of unknown quality without adequate disinfection of the system, before and after. Systems certified for protozoan cyst reduction, may be used with disinfected water containing filterable cysts. EPA Establishment Numb. 070595-MEX-001.

CAUTION:

To reduce the risk of property damage due to possible water leakage:

- Read and follow the instructions carefully before installation and usage of the filter cartridge.
- Protect from freezing by removing the filter cartridge when temperatures are expected to drop below 33° F (1° C).

REPLACEMENT OF THE FILTER CARTRIDGE



IMPORTANT: The filter cartridge MUST be replaced every 6 months at the rated capacity or sooner, if a noticeable reduction in flow rate occurs.

Note: The system is equipped with an internal by-pass valve.

- Turn cartridge slowly to the left until it stops (about a 1/4 turn). In this position, both inlet and outlet ports are closed and water pressure is relieved.
- Pull the used cartridge straight down and discard. Note: There may be a small amount of residual water drainage after pressure is relieved and during cartridge removal.
- Make sure the o-rings are accurately positioned in grooves. Moisten the o-rings with water. Push the new cartridge into the filter head. Turn the cartridge to the right until it stops (1/4 turn). Correct water flow will be restored when positioning of the cartridge is completed.
- Open the faucet or the downstream valve (if installed) and flush new filter cartridge for 2 minutes, expelling any trapped air and carbon fines. Water may run murky because of trapped air but will quickly appear clear.

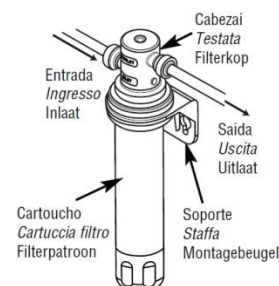
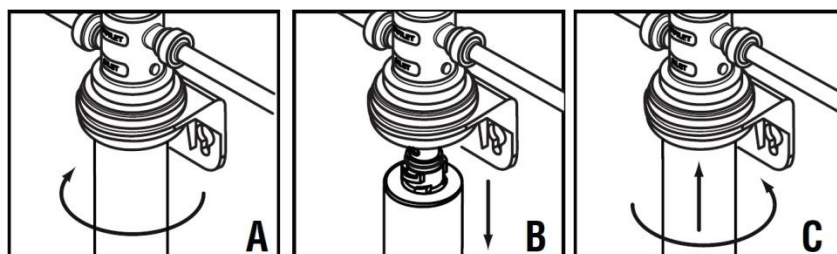

Caution: : this appliance requires periodic maintenance in order to guarantee the drinkability requisites of the treated drinkable water and to maintain the improvements, as declared by the manufacturer.

7. WATER CONNECTION



The system must be connected to the drinking water supply.



If the system includes a filtration system, ensure that all the filter elements are properly installed before making any connection to the water supply.

Refer to the appropriate paragraph or instructions supplied with the filters for installation, maintenance and expiry.

It is recommended to install a valve at the water inlet of the cooler, in order to isolate the system from the water supply whenever it is necessary. When the customer is not able to service, it is recommended to install a device that automatically stops water flow isolating the product from the water circuit (our sales department is available for further technical specifications).

No tools are required to connect the system to the drinking water tube. Connection is carried out easily and within few seconds, simply by inserting the tube directly into the fast fitting located on the back of the product.

This product is supplied with 1/4" fast fitting.



DO NOT USE 6 MM METRIC TUBES AS THESE ARE NOT SUITABLE.

Before connecting the water tube be sure that there are no traces of impurities in the inlet fast fitting. A dust-proof cap may be present in the water inlet fitting, if so, it is necessary to remove it before water tube connection.

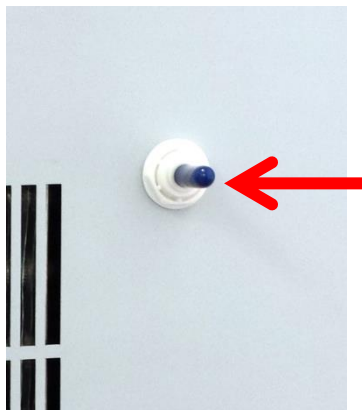

The incoming water pressure must be between 0,250 MPa e 0,500 MPa. The flow rate should be greater than 3 litres/minute.



Check that the pressure remains constant even while water is being dispensed or at least that variations do not exceed 0,050 MPa. If this is not the case, reduce the length of the connection tube, or increase the internal cross-section.

To ensure a state-of-the-art installation, it is recommended to use only certified food-grade tubes and fittings.



CAUTION: If incoming water pressure is unknown, a “water pressure reducer” must be installed and set to 0,250-0,300MPa. Again, check that the pressure is maintained within this range even while water is dispensed, or that variations do not exceed 0,050 MPa.



CAUTION: If an excessive drop in water pressure is detected during delivery, switch off the product immediately and install it strictly in accordance with the above provisions. Insufficient pressure causes damage to the pump in the water carbonation circuit, continuing intervention of the electronic protection device and invalidation of the warranty.



CAUTION: This product produces ice. If a non-return valve or similar device is installed on the inlet of the product (i.e. filtration system with non-return valve), the ice produced may increase the pressure on the water circuit and it is recommended to install a overpressure release valve between the product and the non-return valve.

8.

CARBON DIOXIDE CONNECTION

In order to deliver sparkling water, the system must be connected to a carbon dioxide cylinder fitted with a pressure reducer with an output between 0 and 0,5 MPa.

Use only certified cylinders filled with food-grade carbon dioxide (E290).



The inlet carbon dioxide pressure must not exceed 0,5 MPa. Beyond this value, the pressure security valve on the reducer itself may open up, with a sudden depletion of the cylinder of carbon dioxide.

(060)

Zerica code for the Co2 disposable cylinder replacement is: "BOMB 001".

The Co2 disposable cylinder is placed behind the front panel. To reach the Co2 disposable cylinder, open the front panel by the lock located on the right side of the product.



1. Place the cylinder in the upright position, under the CO₂ reducer.



2. Fasten the cylinder and speed it up when the carbon dioxide starts to come out.
3. Make sure it is well fastened.



CAUTION: *If there is CO₂ coming out, it is necessary to fasten or remove the cylinder and verify the presence and the proper placement of the o-ring seal.*
NOTE: *this operation must be performed quickly to avoid unnecessary CO₂ leakage.*

9. CARBON DIOXIDE PRESSURE REDUCER CONTROL

The pressure regulator makes it possible to vary the amount of carbon dioxide added to the water. Make sure that the reducer is securely screwed to the carbon dioxide cylinder. Poor installation causes the sudden depletion of the cylinder itself.

(070)

The CO₂ reducer is placed behind the front panel. Open the front panel to reach the CO₂ reducer.

1. The control knob is placed on the right side of the system.



2. Turn the control screw clockwise to have more carbonated water.
Following customers preference this value is between 3 and 4 bar.
Turn the control screw anti-clockwise to have less carbonated water.
Following customers preference this value is between 2 and 3 bar.
3. To set the reducer at the maximum value, completely turn the control screw clockwise until it stops.



CAUTION: Do not force the control screw, the reducer may be damaged.

4. The regulation will be effective after dispensing about 2 litres.

10. ELECTRICAL CONNECTION

This product can be supplied with detachable power cord or with a no detachable power cord.



If the detachable power cord is damaged, it must be replaced with a cable available from the manufacturer or its technical assistance service

If the not detachable power cord is damaged, it must be replaced by the manufacturer, its service agent or similarly qualified persons in order to avoid hazard

Make sure that the power supply to the appliance is the same as the voltage indicated on the label on the side of the appliance. The appliance must be grounded in compliance with applicable standards and laws. In case of malfunctioning, grounding reduces the risk of electrical shocks.

Connect the appliance cable to a double-pole switch with a minimum of at least 3 mm distance between the contacts, or using a plug which must still be accessible after installation.

(080)

- Main switch is placed on the back of the appliance.
- The main switch is supplied with a fuse of 10A - 240V and with one replacement fuse.



11. DISPENSING KEYBOARD

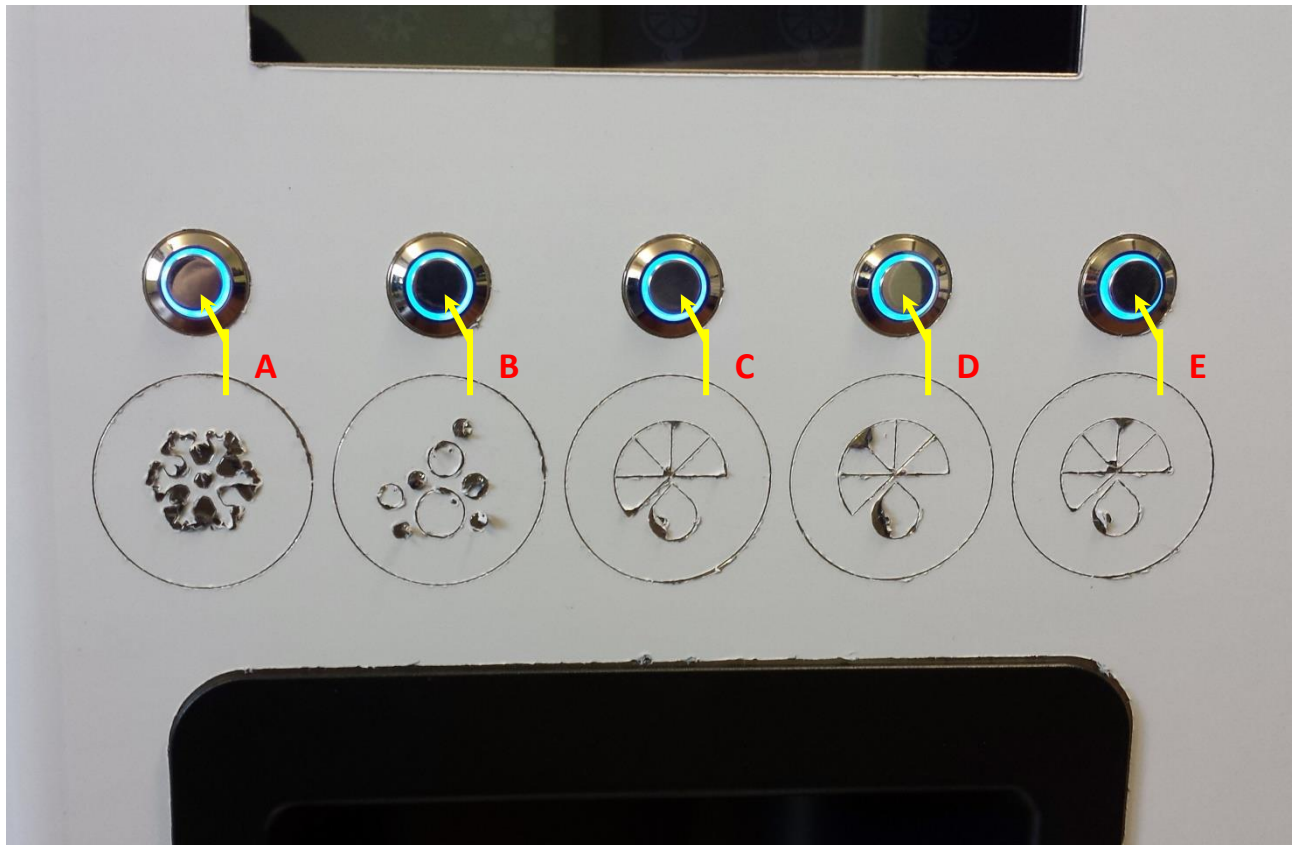

- The A button allows COLD water dispensing.
- The B button allows COLD SPARKLING water dispensing.
- The buttons C, D and E (this one is optional) allow juice from concentrate dispensing.

12.

FIRST POWER-ON

At first power on, it is recommended to proceed as follows:

Cleaning the water system with running water

- a. Keeping the carbon dioxide inlet closed and with power supply in off position, open the water valve and wait a few minutes to make sure there is no water leakage.
- b. Connect the product to the power supply to enable the delivery keys.
- c. Drain at least 30 litres of cold water and a few litres of ambient water.
- d. Press the sparkling water button in order to let the air come out and to fill the carbonator with water. Release the button only when the water starts coming out (delivery will be very slow and this is completely normal).

Air removal from the water system

The presence of air inside the water circuit drastically reduces the mixing of carbon dioxide with water. This condition is highlighted by a whitish colour of the sparkling water supplied that should be always crystal and clear.

In order to remove any air that may be inside the carbonation circuit it is recommended to proceed as follows:

- a. Close the water inlet valve.
- b. Open the valve on the carbon dioxide line.
- c. Connect the product to the power supply to enable the delivery keys.
- d. Press the sparkling water button until all the water inside the carbonator has been dispensed and release only when carbon dioxide comes out.
- e. Keep pressing the sparkling water button for 3-5 seconds and release; repeat this operation for 2 times.
- f. Re-open the water inlet valve.
- g. After 30 seconds, press the sparkling water button for 2-3 seconds. If only carbon dioxide comes out, maintain pressed the sparkling water button until you have sparkling water coming out.

Sparkling water drawing

- a. In order to get a proper mix of Co₂ and water, it is important that the water temperature is low and the air inside the water circuit is completely removed. Remember that any intervention on the water supply line (including filter change), can cause air to enter the system and consequently reduce the amount of carbon dioxide added to the water.
- b. Any air remaining inside the carbonator will be removed while dispensing sparkling water – pls. note that the level of carbonation will improve with the use of the product itself.

With the water circuit perfectly clean and air-bubble free, the carbonator reaches full efficiency after approximately 24 hours of operation.

NOTE: When you first install the product, you have to wait a few hours before dispensing cold water.

13. TOUCH SCREEN POWER ON

GEMINI 1931 is equipped with a stylish design 7-inch wide touch screen, to display commercial videos or other information.

It is possible to turn the touch-screen panel on/off pressing the button as indicated in the figure below:



Please refer to the instruction manual for the touch-screen panel management.

14. BAG IN BOX POSITIONING

Gemini 1931 allows, depending on the model, the dispensing of 2 or 3 fruit juices from concentrate.

- Code GMN T G012 200 allows the dispensing of n. 2 fruit juices from concentrate (dashboard with 4 buttons).
It is possible to place on the stainless steel shelf:
 - n. 2 bag in box up to 7Kg - maximum dimensions cm. 16 x 19 x 25 approx. (L x D x H)
- Code GMN T G012 300 allows the dispensing of n. 3 fruit juices from concentrate (dashboard with 5 buttons).
It is possible to place on the stainless steel shelf:
 - n. 2 bag in box up to 7Kg - maximum dimensions cm. 16 x 19 x 25 approx. (L x D x H) or
 - n. 3 bag in box up to 4kg - maximum dimensions cm. 9 x 19 x 25 approx. (L x D x H)

Bag in boxes are placed behind the front panel, on the stainless steel shelf.

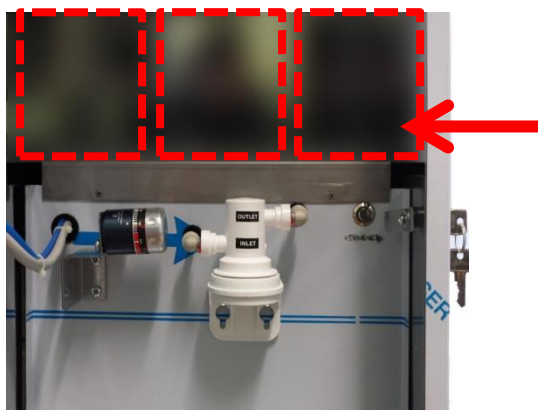

15. WATER - CONCENTRATE MIXING CONTROL

To obtain higher or lower juice concentration proceed as follows:

- a. Open the frontal compartment by using the safety key.



- a. Set the degree of concentration by the mean of the regulators (C) (D) and (E) (optional)

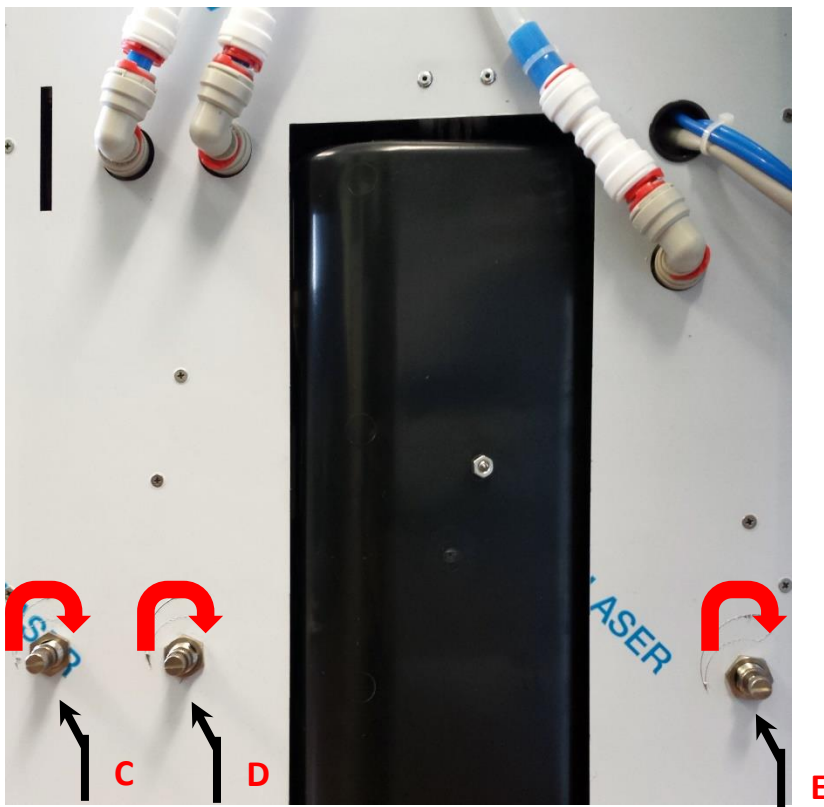

Note: regulator C and E are inverted in all series with serial number up to 105300

- b. To increase the concentration of juice rotate the regulator (G) in clockwise direction. For lower concentration rotate the regulator (G) in anti-clockwise direction.
- c. At the end of the procedure tighten the screw nut (S) which is behind the regulator.



CAUTION: do not use any tool for the regulation of juice concentrate. Only the finger must be used. Do not tighten the safety nut with excessive force.

Regulation is effective after dispensing few glasses.

To know the precise brix value to be set, refer to the label on the concentrate for complete information. To know the precise brix value set, use a commercially available refractometer.



CAUTION: if the main water pressure is unstable or insufficient, the regulation of the brix can not be maintained according to constant values.

16. GLASS / CARAFE SUPPORT INSTALLATION

The front panel is equipped with 6 supports for the installation of the glass / carafe support grill on different levels:

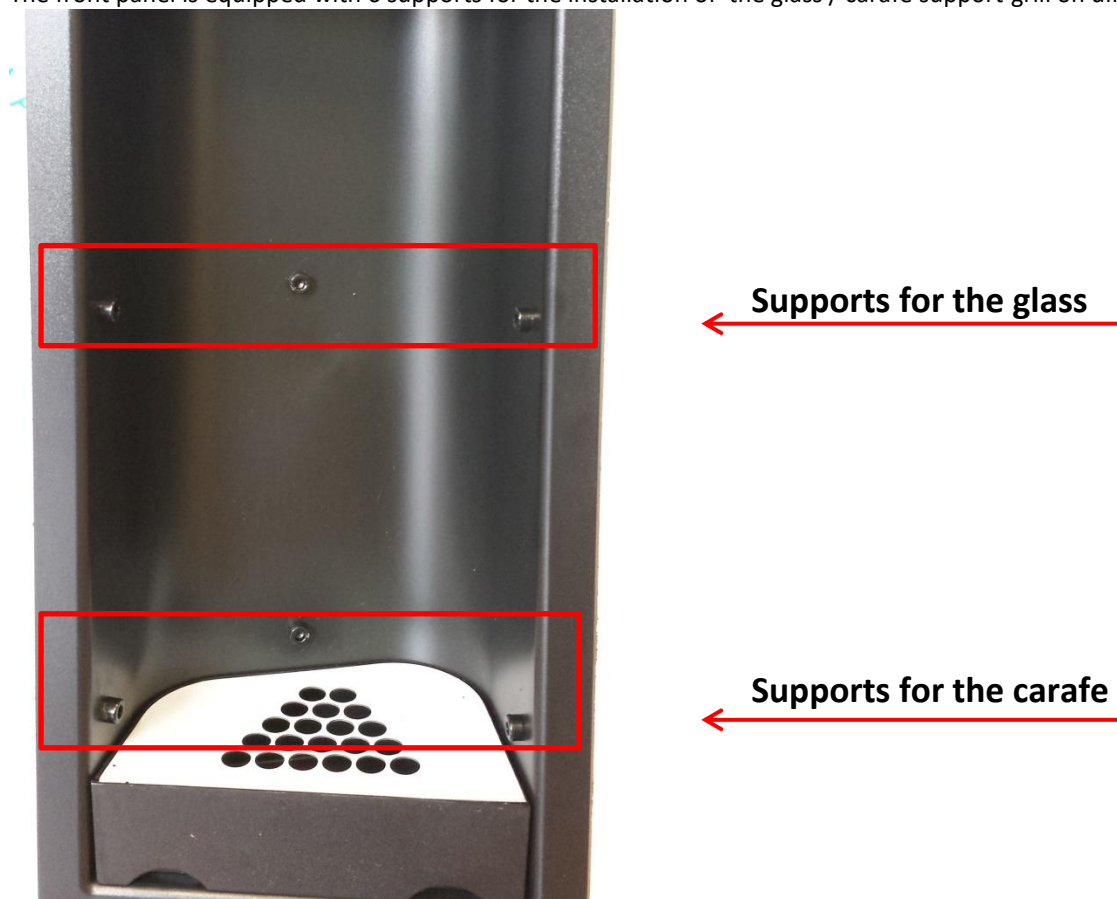

To place the glass / carafe grill support, tilt the grill to allow the central pin to be inserted and then proceed with the lateral ones.



The support grill has got two rubber “stops” that guide the positioning of the glass. If necessary the “stops” can be removed:



Glass support grill installation:



Carafe support grill installation, without rubber stops:



17. THERMOSTAT CONTROL

It is possible to enable and disable cold water dispensing as well as temperature control by acting on the thermostat. During periods with low water collection it is better to set the thermostat at minimum (anti-clockwise).

During periods with high water collection it is better to set the thermostat at maximum (clockwise). In this way the cooling circuit is able to provide an ice reserve that would be necessary during the times of high operation of the machine.

To modify the temperature just turn the control handle (or the regulation screw) following the label placed near the thermostat. Higher values means colder water.



NOTE: It will take a couple of hours before the temperature is changed to the new value set.

18. ALARM WARNINGS

Behind the front panel (on the right of the filter) there is a warning light.
BLU LIGHT on the keyboard will be visible in case of an alarm.



1. The warning light performs a continuous cycle of 3 fast flashes and a 1 second pause

REASON : 6 months have passed since the last reset of the system.

It is necessary to perform a general maintenance to make sure the system is working properly.

2. The warning light performs a continuous cycle of 3 slow flashes and a 1 second pause

REASON : about 3000 litres have been supplied.

It is necessary to perform a general maintenance including filter replacement (if filter is present) or any other device whose functionalities are strictly dependent on the use of the product.

RESET

After proper maintenance, it is possible to reset the microprocessor. Proceed as follows:

1. Turn off the product
2. Push A button and C button simultaneously
3. Turn on the product
4. Release the A and C buttons after (at least) 3 seconds.

The reset has been completed when the BLU LIGHT performs 10 fast flashes.

The reset brings to zero all counters : months and hours of supplying.

3. The warning light remains on (only series 090 - 270)

REASON : pump time out

During normal conditions of operation, the pumping unit remains active for approximately 30 seconds after each sparkling water distribution. In case of low inlet water pressure or with excessively sparkling water collection, a protection system will automatically disable the sparkling water production system with the aim of preserving the inner components.

This block causes the emission of carbon dioxide instead of sparkling water.

RESET

To reset the sparkling system, simply disconnect the product from the power supply, wait about five/ten minutes and reconnect.



CAUTION: a low inlet pressure may damage the pumping unit placed in the sparkling water circuit and may cause the continuous intervention of the electronic protection.

(150)

19. COOLING CIRCUIT MAINTENANCE

The cooling system requires no maintenance. Leave a gap of at least 5 cm on each side. This gap must be at least 25 cm by the ventilation slots. Periodically check that the ventilation slots are clear and not obstructed, then remove any impurity deposited on the ventilation slots using a brush or a vacuum cleaner.



CAUTION: Failure to clean the condenser and poor ventilation of the cooling circuit can cause the compressor to overheat and break. These causes invalidate the WARRANTY and any repair cost will be charged.

(130)

20. WATER CIRCUIT MAINTENANCE

Cleaning should take place at the following times:

- The first time the product is installed (dispense some water for at least a couple of minutes)
- When parts or pieces in contact with water are replaced
- When pollution is suspected or has occurred. This may manifest itself as a bacterial infection with a bad smell/taste of the water or if the water is cloudy.
- Any new installation
- If system has not been used for 5 days

(140)

21. DRIP TRAY AND FRONT PANEL MAINTENANCE

The front panel and the drip tray should be cleaned at least once a day. To disassemble the drip tray insert the fingers into one of the frontal housing (hole) of the drip tray, then lever the back side of the drip tray up, as indicated in the figure below:



Use only non-toxic products suitable for plastic to clean the drip tray and the front panel. Do not use solvents.

22. FRONT PANEL REMOVAL

With the front panel removal it is possible to perform a rapid inspection of the water / concentrate mixing system.



CAUTION: do not force the plastic panel, it may be damaged.

1. Close the water inlet
2. Press the cold and ambient water delivery keys to eliminate the water pressure
3. Disconnect the product from the power supply
4. Remove the drip tray and empty it



5. Unscrew the Phillips screw

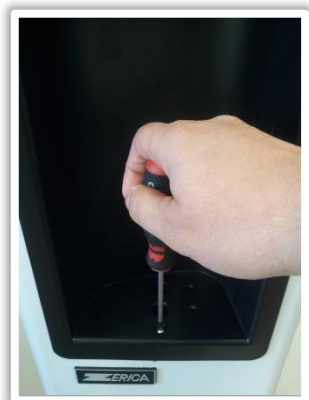

6. Gently push upward and remove the front panel as shown in the following pictures:

7. Place again the front panel in the original position, with a gentle movement from top to bottom.

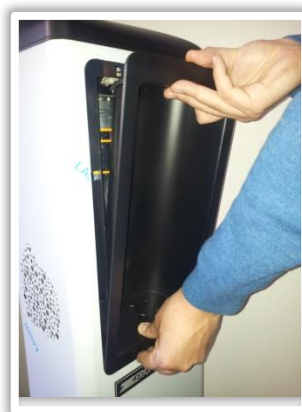

IF THE PANEL IS NOT PERFECTLY ADJACENT TO THE STAINLESS STEEL CABINET, DO NOT FORCE IT BECAUSE THE ANCHOR HOOKS MAY BE OVERFORCED AND BRAKE.



8. When the panel is perfectly adjacent to the cabinet, gently push it down and reassemble the fixing screw.

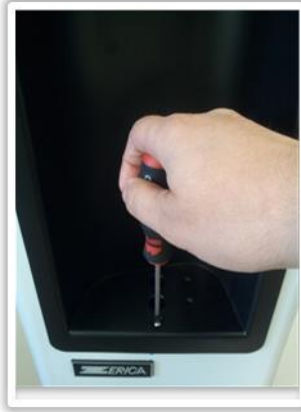

23. CONCENTRATES CIRCUIT MAINTENANCE

- A. It is necessary to clean the compartment with the bag in box weekly and in any event every two or three substitution of the bag in box. When removing the empty box, residuals of concentrate may remain in the nozzles. By weekly cleaning you assure complete removal of such residuals is assured.
- B. It is recommended to carry out the cleaning whilst replacing the empty bag in box. Please proceed as follows:
1. Open the compartment and remove the empty cartridges.
 2. Disconnect the bag in box connectors from the pipes
 3. Press and hold each button of the fruit juice supply for approx. 10 -20 seconds to remove any concentrate residual from the pipes. Wait for clear water coming out from the dispenser.
- C. Monthly check that the non return valves (V) are free of any concentrate residues or deposits; disassemble and rinse them with warm water.



IF A NON RETURN VALVE IS BLOCKED, CONCENTRATE MAY DRIP FROM THE DISPENSING NOZZLE CAUSING THE EMPTYING OF THE BAG IN BOX.

- D. Replace the silicon pipes (S) at least every 3-6 months.



IF NECESSARY, PERFORM AN INTENSIVE CLEANING. IT IS POSSIBLE TO CONNECT THE PIPES TO BAG IN BOX OR CONTAINER FILLED WITH A COMMERCIAL AVAILABLE FOOD GRADE DISINFECTANT.

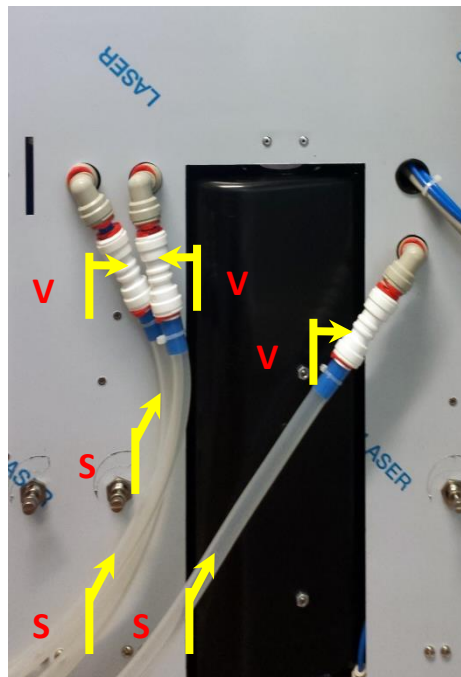

24. RINSING FRUIT JUICE LINES (serial number from 105300)

At the end of each cycle of work it is recommendable to remove every remaining of fruit juice (concentrate mixed with water) which rests inside the dispensing pipes.

To proceed with rinsing it is necessary to:

- a. Arrange a waterproof container in the dispensing area.
- b. Open the front compartment using the lock on the right side of the machine.
- c. To rinse at the same time all of the dispensing pipes, push simultaneously for few seconds the button "SERVICE" and any other dispensing button.

While these two button are pushed (SERVICE and JUICE) let water simultaneously flow through the 2 (3 optional) dispensing pipes.

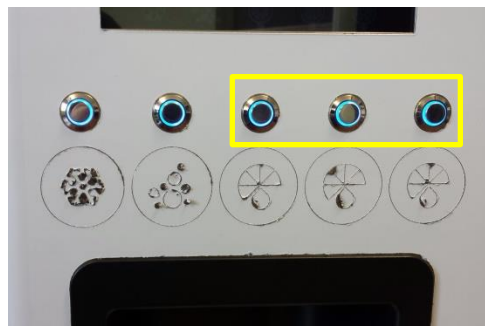

25.

MAINTENANCE CHART

Date of installation	Customer	
Address	Tel.	Installation company

Model	SERIAL NO.

RESPECT MAINTENANCE DATES DURING WARRANTY (see warranty clauses)

Date	Litres	Replaced parts	Service centre

(200)

26.

DEMOLITION AND DISMANTLING

The user has the obligation to dispose of the device at the end of its life cycle in compliance with the current regulations and in particular the requirements of the WEEE directives, regarding the disposal of equipment and machines.



This symbol on the product or in the instructions means that your electrical and electronic equipment should be disposed at the end of life separately from household waste. There are separate collection systems for recycling in the EU. For more information, please contact the local authority or your retailer where you purchased the product.

(210)

27.

WARRANTY

ZERICA® S.r.l. guarantees ZERICA® products purchased from ZERICA® S.r.l. or from an authorised dealer against material or manufacturing defects, on the conditions that the ZERICA® products are new at the time of purchase. The product is covered by a **legally-compliant warranty** as follows:

for consumers, i.e. persons who purchase for purposes unrelated to their profession or business, the seller shall apply Italian Legislative Decree n° 24 of 2 February 2002 art. 1519-bis et seq. of the Italian Civil Code (two years from delivery in compliance with legal requirements)

for other purchasers, who usually purchase for their profession or business, the legal warranty referred to in articles 1490 et seq. of the Italian Civil Code shall apply (one year from delivery in compliance with legal requirements).

During the period of validity of the warranty, ZERICA® undertakes to repair or replace free of charge those parts which, within the warranty period, prove to be inefficient in its opinion. Total replacement of the appliance is not included and claims for compensation for damages, caused in whatever circumstances, shall not be acknowledged. Repairs shall be performed at our authorised Service Centre.

For repairs at home, the customer is required to pay a “set charge” as partial reimbursements for travelling costs for personnel.

For repairs in the laboratory, the products must be shipped to an Authorised Technical Service Centre, enclosing your name, address, telephone number and a description of the problem and in any event by filling out the RMA form. Transport costs shall be borne by the purchaser. You can get more information by contacting ZERICA® S.r.l. at the address below. There may be delays in the repair or replacement of components that are found to be faulty at source, in the event that they are not in stock.

The warranty excludes those products that (I) in the opinion of ZERICA® have been damaged accidentally or during transportation if not notified to ZERICA Srl® directly within 8 days from the date of purchase, or due to incorrect or improper use or inappropriate or incorrect application, or following intervention or verifications or modifications carried out by anyone other than a ZERICA® Authorised Service Centre (tampering), or (II) in relation to defects or non-functioning as a result of normal wear and tear, or (III) where there has been a breach of your contractual obligations. If, after investigation by ZERICA® S.r.l., your request for repair/replacement under the warranty is found not to fall under the scope of the situations or the duration of this warranty, the expenses incurred for said investigation and repair/replacement shall be borne solely by the purchaser. The following are excluded from the warranty: knobs, moving or removable components, glass parts, light bulbs or indicator lights, data plates, all accessories and saturated filters. ZERICA® S.r.l. shall not be liable for any damage caused directly or indirectly to persons or property following failure to observe all the instructions provided in the booklet accompanying the appliance. The warranty limitations and disclaimers above are only limited by mandatory rules and shall therefore be effective to the maximum extent permitted by such rules.

The Court of Palermo is the only competent court for any dispute.

Validity of the warranty. The product warranty is valid **only** if the coupon is completed in its entirety and sent by fax or e-mail **within 8 days of the date of purchase** to ZERICA® S.r.l.

Complete the “Code n°” with the serial number present on the data plate affixed to the product.

The warranty certificate remains in the possession of the purchaser and must be presented to technical personnel or accompany the appliance if sent for repair.

(220)

GARANZIA



1 dati del proprietario		2 dati del proprietario	
nome e cognome		nome e cognome	
via		via	
c.a.p.	città	c.a.p.	città
	prov.		prov.
modello		modello	
timbro del rivenditore	matricola	timbro del rivenditore	matricola
data di acquisto		data di acquisto	

28.

EC DECLARATION OF CONFORMITY

Manufacturer: ZERICA s.r.l.

Address: Zona Industriale – 90018 Termini Imerese (PA)

Declares under its responsibility that this product:

Complies with the requirements of EEC Directive (2006/95/EC) - low tension directive

Complies with the requirements of EEC Directive (2004/108/EC - EMC) – electromagnetic compatibility;

Electrical safety:

- CEI EN 60335-1 :2013-01
 - Safety of electrical appliances for household and similar use. Part 1: General requirements..
- CEI EN 60335-2-89/2011
 - Electrical appliances for household and similar purposes - Safety. Part 2: Particular requirements for appliances for commercial refrigeration condensing unit of refrigerant, compressor or an incorporated or remote

Electromagnetic compatibility:

- CEI EN 55014-1/2008+A1-2010+A2-2012
Electromagnetic compatibility. Requirements for household appliances, electric tools and similar apparatus. Part 1: Emission.
- CEI EN 55014-2/1998+A1-2002+IS1-2007+A2-2009
 - Electromagnetic compatibility. Requirements for household appliances, electric tools and similar apparatus. Part 2: Immunity.
- CEI EN 61000-3-2/2007+A1+A2-2011 Part 3-2:
 - Electromagnetic compatibility. Part 3: Limits - Section 2: Limits for harmonic current emissions (equipment input current less than 16A per phase).
- CEI EN 61000-3-3/2014
 - Electromagnetic compatibility. Part 3: Limits - Section 3: Limitation of voltage fluctuations and flicker in low-voltage supply systems for equipment with rated current less than 16A and not subject to conditional connection.

Declares under its responsibility that this product:

- Complies with Directive 2011/65/CE (RoHS 2)- “Restricting the use of certain hazardous substances in electrical and electronic equipment” - RoHS.
- The carbonators used by ZERICA S.r.l. have been designed and produced according to sound engineering practice, tested according to the reference procedures and are suitable for use in systems for producing sparkling water, using only drinking water and CO2 at a maximum operating pressure of 7 bar.
- The carbonators are inserted in systems subject to the Machinery Directive (89/392/EC) or the Low Voltage Directive (73/23/EC) and therefore do not fall within the scope of the Pressure Equipment Directive - PED (97/23/EC) according to the exclusions in art. 1 point 3.6. of said Directive.
- In addition, the models of carbonators used by Zerica have a product PSxV below the limit established by the PED, at 50, and do not therefore have to be CE-marked as they come under the equipment referred to in art. 3§3 in said directive.

(230)

Zerica has also requested verification of conformity assessment pursuant to the Italian Decree of 6 April 2004 no. 174 in appliance to REGULATION (EEC) N. 1935/2004 - "materials that come into contact with the water destined for human consumption" for the following components:

- Plastic fittings in contact with water are NSF, FDA and SK certified and meet the Italian provisions of the ministerial decree no. 174 of April 06, 2004
- Plastic tubes in contact with water are NSF, FDA and SK certified and meet the Italian provisions of the ministerial decree no. 174 of April 06, 2004
- Turboclean system - consisting of stainless steel components - "Test Report No. 1206/09 issued on 11 May 2009 by G.R. Biochemilab in Modena.
- Stainless steel coils and stainless steel pipes - "Test Report No. 1200/09 issued on 11 May 2009 by G.R. Biochemilab in Modena.
- Brass fittings - "Test Report No. 1202/09 issued on 11 May 2009 by G.R. Biochemilab in Modena.
- Brass fittings - "Test Report No. 1203/09 issued on 11 May 2009 by G.R. Biochemilab in Modena.
- HPDC system - consisting of food-grade copper components - "Test Report No. 1201/09 issued on 11 May 2009 by G.R. Biochemilab in Modena.
- Plastic fittings - "Test Report No. 51/10 AMB issued on 10 December 2010 by Bioanalisi in Erice.
- Nickel-plated brass fittings - "Test Report No. 51/10 AMB issued on 10 December 2010 by Bioanalisi in Erice.
- Brass fittings - "Test Report No. 51/10 AMB issued on 10 December 2010 by Bioanalisi in Erice.
- Plastic taps - "Test Report No. 51/10 AMB issued on 10 December 2010 by Bioanalisi in Erice.
- Plastic head - "Test Report No. 51/10 AMB issued on 10 December 2010 by Bioanalisi in Erice.
- Teflon chamber - "Test Report No. 51/10 AMB issued on 10 December 2010 by Bioanalisi in Erice.
- Blue plastic diffuser - "Test Report No. 51/10 AMB issued on 10 December 2010 by Bioanalisi in Erice.
- AISI 304 stainless steel chamber - "Test Report No. 51/10 AMB issued on 10 December 2010 by Bioanalisi in Erice.
- Glass bottle - "Test Report No. 51/10 AMB issued on 10 December 2010 by Bioanalisi in Erice.

Wherefore states the conformity of the appliance to the Decree of April 06, 2004 no.174

- **Turboclean system - consisting only of components codes SL BARIL OXX is Tested and Certified by NSF International**



(231)



Thirsty for innovation.

www.zerica.com • info@zerica.com

ZERICA srl

Zona Industriale

90018 Termini Imerese (Pa) - Italy

Tel. +39.091.8140341 – 091.8140377 – 091.8167962 – 091.9293333 Fax +39.091.8140364

<http://www.zerica.com> e-mail: info@zerica.com

Sono vietate la riproduzione totale e parziale. La Ditta costruttrice declina ogni responsabilità per eventuali errori di stampa contenuti nel presente foglio. Si riserva inoltre il diritto di apportare, senza preavviso, le modifiche che si riterranno utili ai propri prodotti senza comprometterne le caratteristiche essenziali.

(300)